

unibox

WELCOME

Safe-Vu

Screen System



Introducing

Safe-Vu

– the range of flexible, hygienic protective screens from the UK's leading producer of aluminium-based screen systems.



Safe-Vu uses specially-engineered rubber fins to deliver unparalleled levels of stability. As the acrylic panels are pushed into position, the fins deflect to hold them firmly in a vice-like grip.

Safe-Vu screen systems are built using lengths of our AluGrip6 extruded aluminium profiles. Precision-anodised and cut using state-of-the-art CNC machinery, these profiles have been designed to create protective screens that suit desks and workspaces of all shapes, sizes and functions.

Introducing

Safe-Vu

– the range of flexible, hygienic protective screens from the UK's leading producer of aluminium-based screen systems.



Please Note: Top Cap is pre-fixed to the post.

- Straightforward, Tool-Free Assembly – thanks to the inclusion of rubber fins, Safe-Vu systems can be assembled easily and quickly without the need for any specialist tooling or prior experience.
- Rapid Delivery – all Safe-Vu screens and accessories are designed, developed and manufactured at Unibox's 4000m² production facility. This means large-volume orders can be delivered and installed within short lead times, regardless of whether the product dimensions are standard or bespoke.
- Unparalleled Stability – solid aluminium profiles are used to support the acrylic panels ensuring they remain secure and stable at all times. Additional fixing brackets can be incorporated to screw, bond or clamp Safe-Vu screens onto desks and workspaces.
- Elegant Design – we believe that there is no reason why protective screen systems should look unsightly. Designed to be slimline and transparent, the Safe-Vu range provides a sleek, elegant solution that blends seamlessly into all commercial environments.
- Easy to Store – recognising the importance of functionality and flexibility, we designed all of the components that form Safe-Vu screens to be flat-packable so that they can be stored easily if necessary. All systems are supplied with clear, tool-free assembly instructions.
- Hygienic – all of the aluminium profiles, acrylic panels and accessories can be sanitised quickly and easily with standard household disinfectants.
- Ultra-Flexible – the Safe-Vu range can be used to construct screen arrangements of all shapes and sizes according to your specific spatial requirements. Screens can be extended or reconfigured to suit any changes in the layout of a workspace.

As we face an unprecedented time in our lives, it's important now more than ever to look after each other and keep each other safe.

We've asked ourselves; what we can do today, that would make a difference tomorrow?

Our modular aluminium system that we have in stock can be quickly fabricated to create protection devices to be used in areas where people still must interact with one and other.

Fin

Fin uses cutting-edge AluGrip6 technology – a range of supportive feet and connective brackets that securely lock laser-cut panels of 6mm acrylic together. AluGrip6 systems offer unparalleled flexibility and are ideal for use in reception areas, retail spaces, commercial offices, cafes and more.

Pg. 11

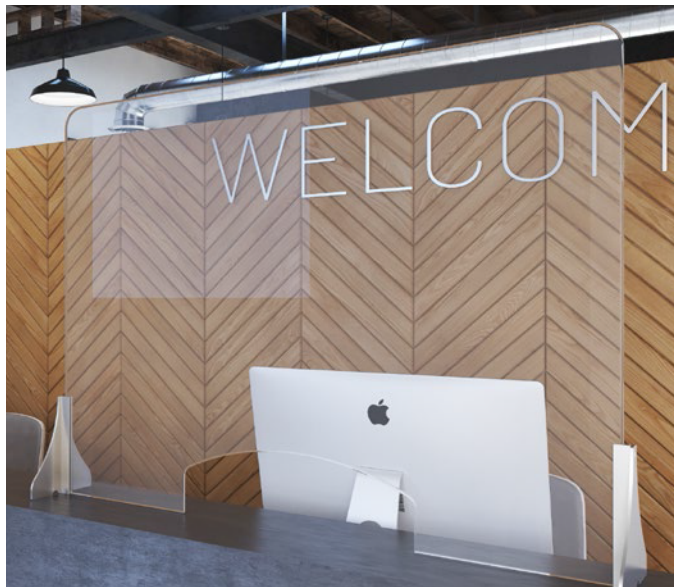

Float

Float utilises a range of specially-developed aluminium profiles to create a vast array of easy-to-assemble screen systems that are structurally robust whilst remaining elegant and visually inconspicuous.

Pg. 11



Free

Free systems are built using strong, aluminium-framed screens and are available in a range of options – static, mobile and portable. All Free systems are highly-stable yet stylish, making them ideal for use in offices, large commercial spaces and production environments.

Pg. 23





Fin

is a range of free-standing screens that has been designed for use in a variety of environments including reception areas, offices, customer service desks and flexible meeting spaces. Fin systems can be supplied with or without access ports and can be manufactured according to client-specific dimensional requirements.



chris hartmann
design

Fin

Fin systems can be supplied with or without access ports and can be manufactured according to client-specific dimensional requirements.



BASE-01



Steel Base

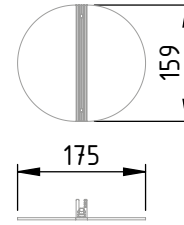

BASE-02



Steel Side

BASE-03



6mm Acrylic Side

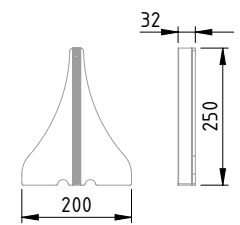

FIN-60x60-B

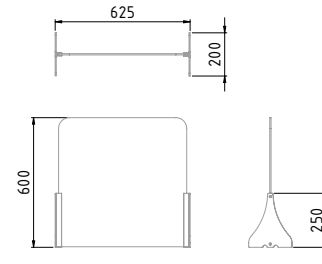

FIN-60x60-BC

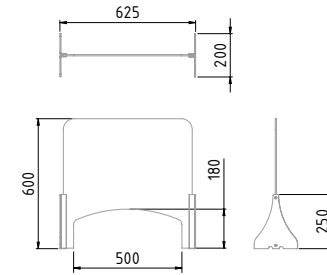

FIN-90x60-B

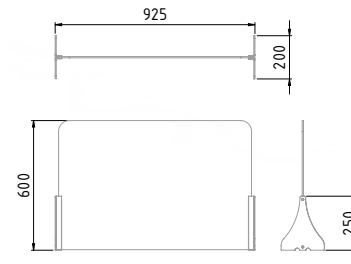

FIN-90x60-BC

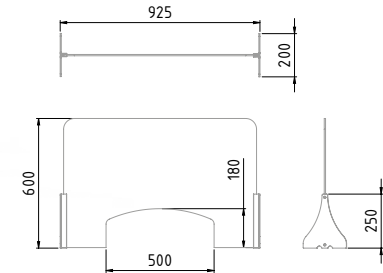

Product code.	Fin Dimensions mm (WxH)
FIN-60x60-B-(Base Code)	600x600
FIN-60x60-BC-(Base Code)	600x600
FIN-90x60-B-(Base Code)	900x600
FIN-90x60-BC-(Base Code)	900x600

Custom sizes available

Fin

Fin systems can be supplied with or without access ports and can be manufactured according to client-specific dimensional requirements.

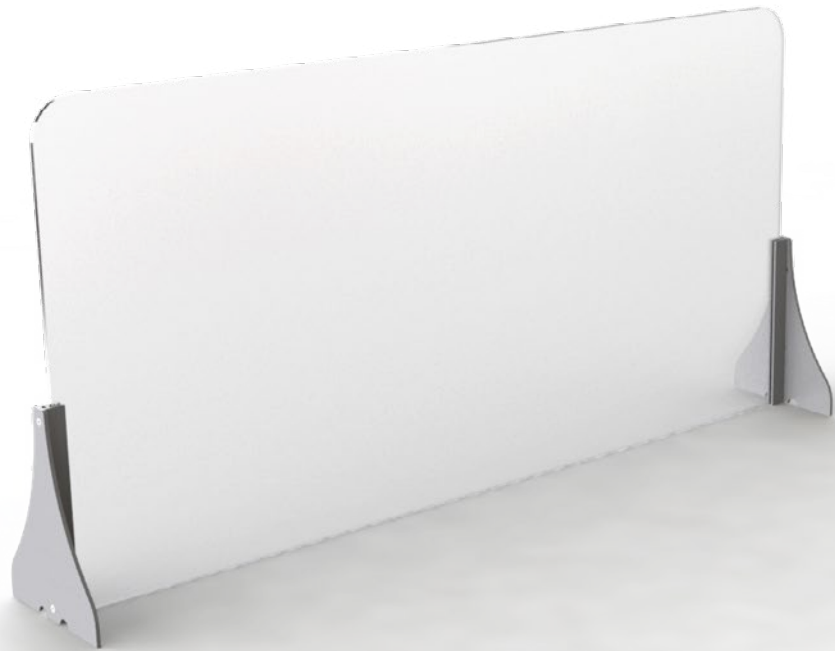

BASE-01

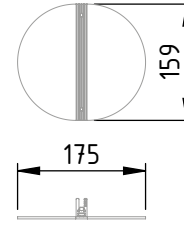

BASE-02



BASE-03

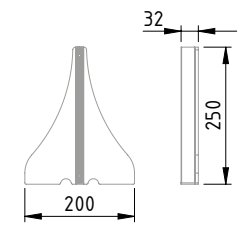

FIN-120x60-B

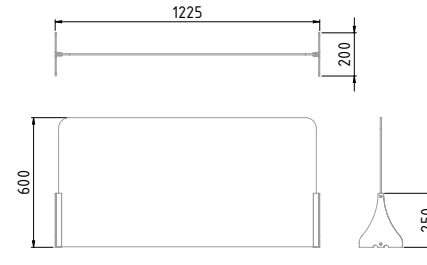

FIN-120x60-BC

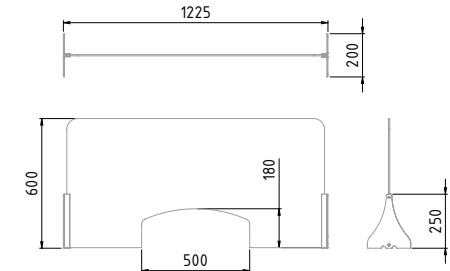

FIN-160x60-B



FIN-160x60-BC

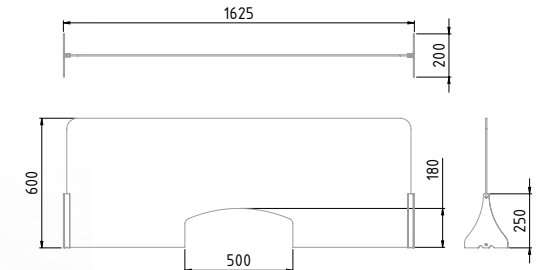

Product code.	Fin Dimensions mm (WxH)
FIN-120x60-B-(Base Code)	1200x600
FIN-120x60-BC-(Base Code)	1200x600
FIN-160x60-B-(Base Code)	1600x600
FIN-160x60-BC-(Base Code)	1600x600

Custom sizes available

Fin - High

Fin systems can be supplied with or without access ports and can be manufactured according to client-specific dimensional requirements.



FIN-160x100-HC

BASE-02



Steel Side

BASE-03



Acrylic Side

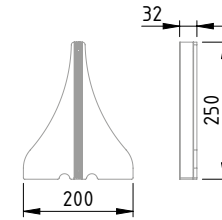

FIN-120x100-H

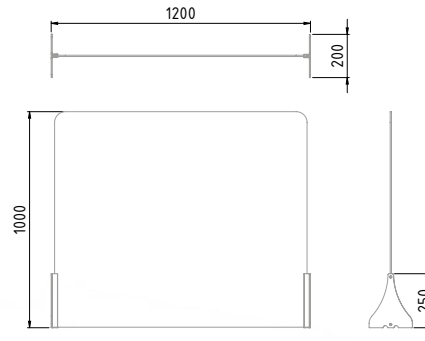

FIN-120x100-HC

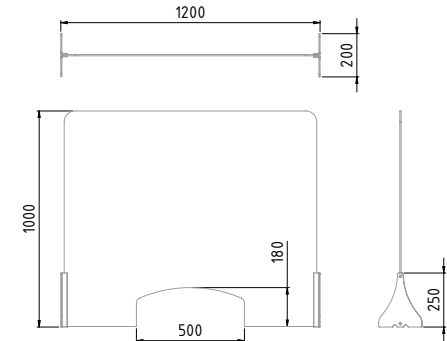

FIN-160x100-H



FIN-160x100-HC

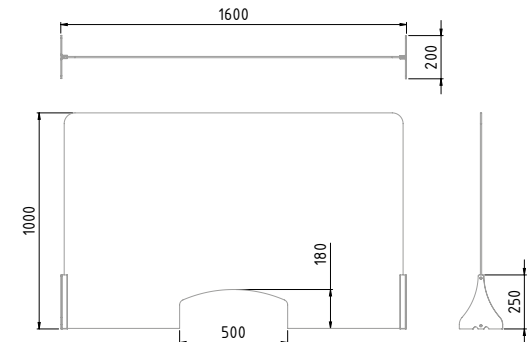

Product code.	Fin Dimensions mm (WxH)
FIN-120x100-H-(Base Code)	1200x1000
FIN-120x100-HC-(Base Code)	1200x1000
FIN-160x100-H-(Base Code)	1600x1000
FIN-160x100-HC-(Base Code)	1600x1000

Custom sizes available



Fin - Clear

Free-standing Fin screens are built using 6mm panels of laser-cut acrylic to create aesthetically discrete, precise solutions.

Featuring laser-cut slots in the acrylic panels and corresponding slots in the acrylic feet, Fin screen systems are straightforward to assemble and don't require the need for specific training or tools.

Fin - Clear

Fin systems can be supplied with or without access ports and can be manufactured according to client-specific dimensional requirements.

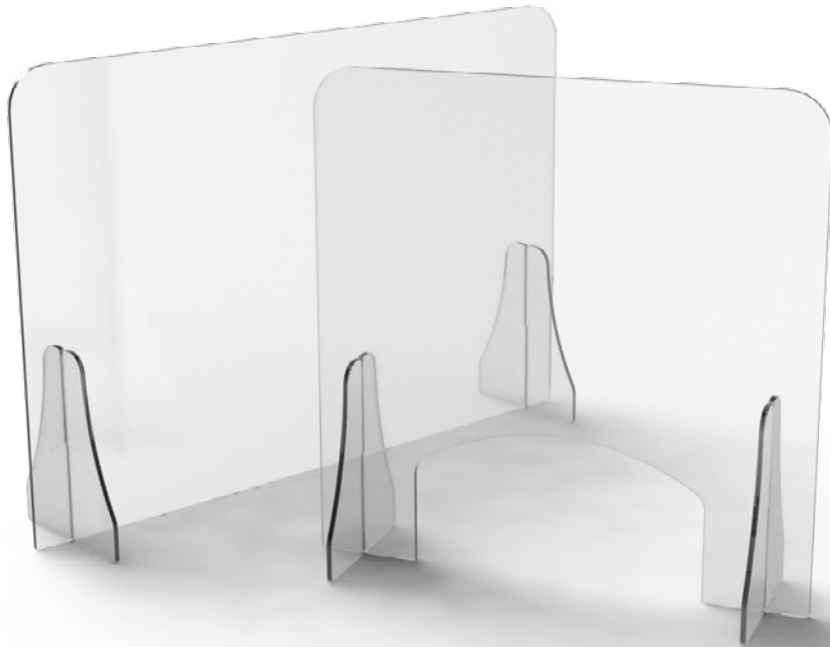

FIN-CLR-60x60

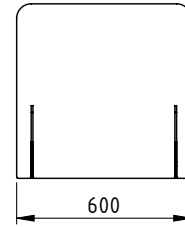

FIN-CLR-60x60-C

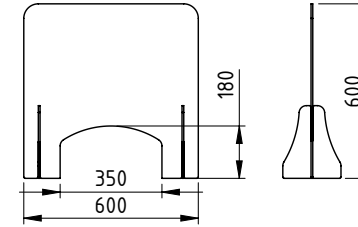

FIN-CLR-90x60

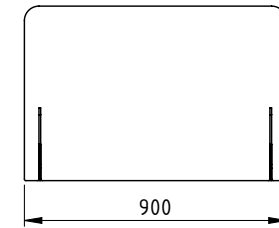

FIN-CLR-90x60-C

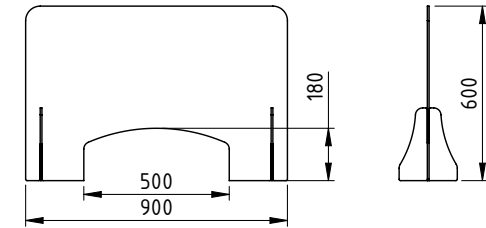

FIN-CLR-120x60

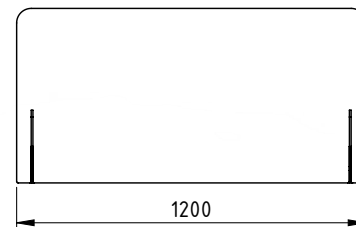

FIN-CLR-120x60-C

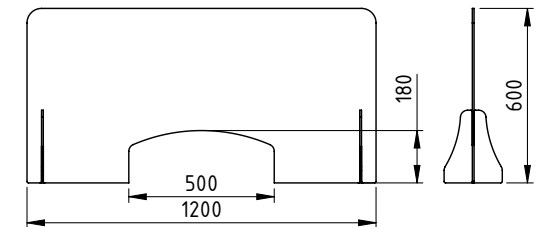

Product code.	Fin Dimensions mm (WxH)
FIN-CLR-600x60	600x600
FIN-CLR-90x60	900x600
FIN-CLR-120x60	1200x600
FIN-CLR-60x60-C	600x600
FIN-CLR-90x60-C	900x600
FIN-CLR-120x60-C	1200x600

Custom sizes available

Fin - Accessories

- Fin systems are available with optional base plates to offer additional stability and support. Base plates include non-slip rubber pads and can be supplied with screws for fixing screens directly to a surface.
- 90° corner brackets can be used in conjunction with Fin base plates to enable the creation of a wide variety of bespoke screen arrangements.
- Desk clamps engineered using AluGrip6 technology can be included to secure screen systems to work surfaces and offer an additional level of stability.

90° corner Bracket

FIN-90CRN



Desk Clamps

FIN-DSK-CLMP-01



FIN-DSK-CLMP-02



Fin Base Plates

FIN-BASE-01



Steel Base

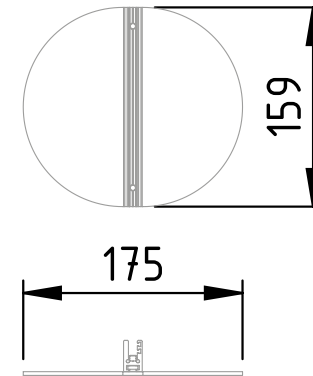

Base to flush fix screen to front edge of the mounting surface. *Must be fixed in place*

FIN-BASE-04

FIN-BASE-02



Steel Side

FIN-BASE-03



6mm Acrylic Side

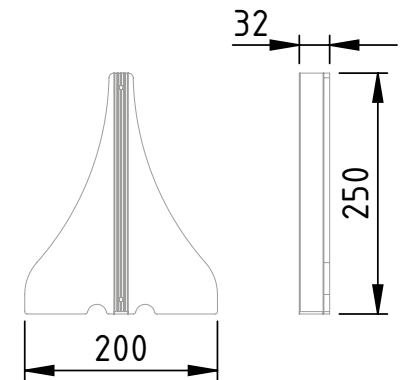



Float



ohle hartmann
design

Float is a range of robust yet visually elegant protective screens. Built using transparent acrylic panels and anodised aluminium profiles, Float systems blend seamlessly into commercial spaces of all types whilst making no compromises in the levels of protection delivered at each individual workstation.



Float screen systems can be built using an array of different aluminium profiles and connectors, all of which have been designed by Unibox in-house. Each profile is fitted with a colour-matched end-cap to ensure panels are aligned precisely. Using our Float configurator, you can explore the range of different options that are available and select one to suit your specific requirements.



Double Float - Configurator

Posts fixed to desk through base plate.

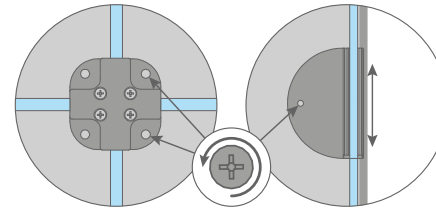

Divider brackets can be positioned anywhere along the length of the divider. With a screw hole for fixing if required.

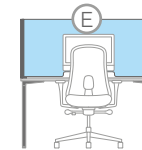
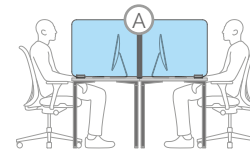
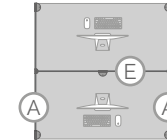
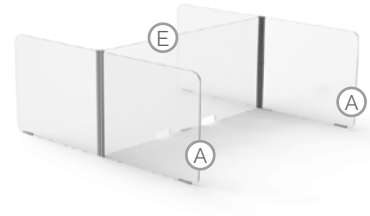

Desk size: 1400x700
End Bay: A1
Qty: 2
Mid Bay: NA
Qty: NA
Divider: E2
Qty: 1

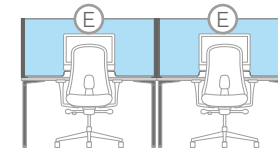
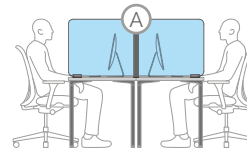
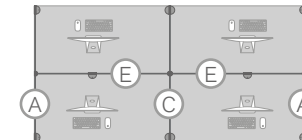
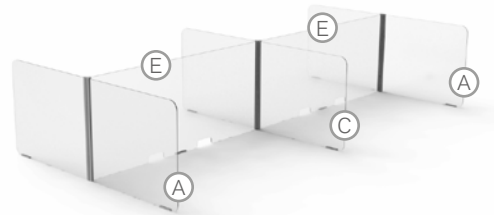

Desk size: 1400x700
End Bay: A1
Qty: 2
Mid Bay: C1
Qty: 1
Divider: E2
Qty: 2

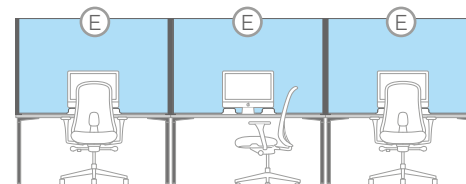
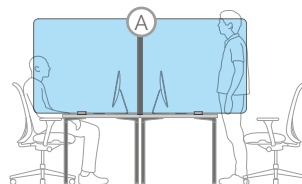
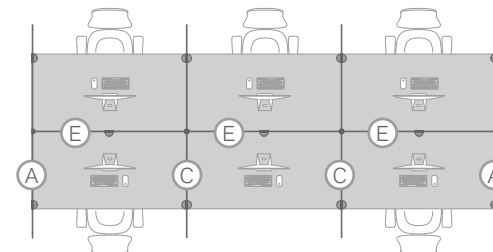
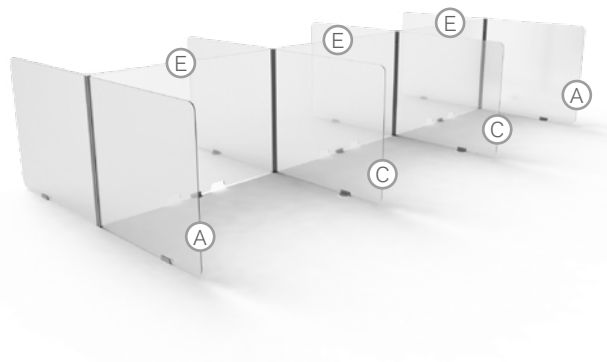

Desk size: 1600x800
End Bay: A6
Qty: 2
Mid Bay: C6
Qty: 2
Divider: E7*
Qty: 3

*Custom divider size required due to desk run length.

Single Float - Configurator

Posts fixed to desk through base plate.

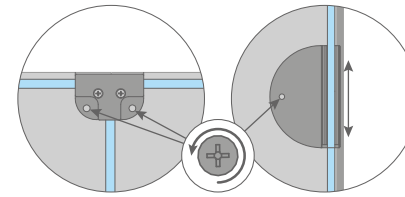

Divider brackets can be positioned anywhere along the length of the divider. With a screw hole for fixing if required.

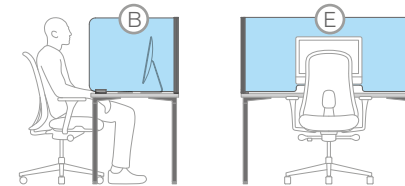
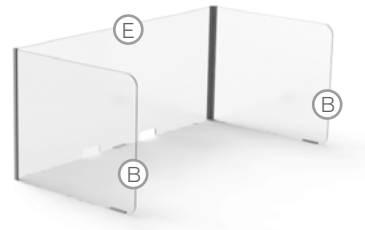

Desk size: 1400x700
End Bay: B1 & B2
Qty: 1 (of each)
Mid Bay: NA
Qty: NA
Divider: E2
Qty: 1

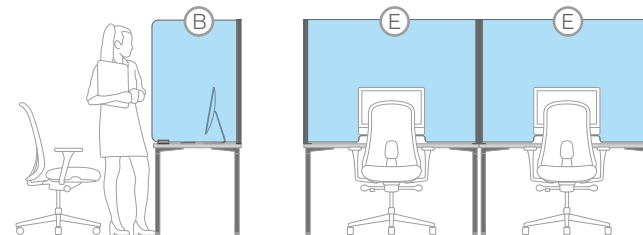
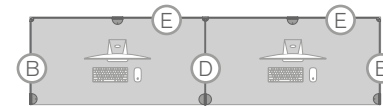
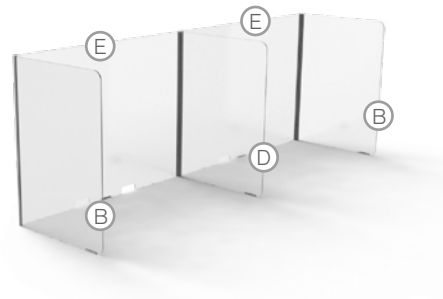

Desk size: 1400x700
End Bay: B7 & B8
Qty: 1 (of each)
Mid Bay: D4
Qty: 2
Divider: E5
Qty: 2

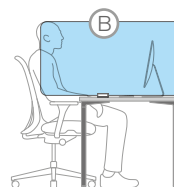
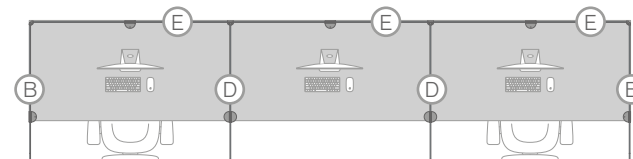
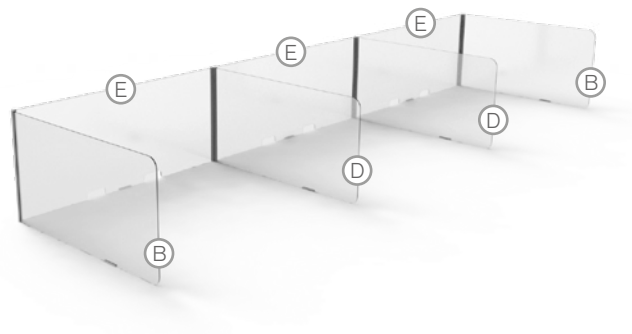

Desk size: 1600x800
End Bay: B3 & B4
Qty: 1 (of each)
Mid Bay: D2
Qty: 2
Divider: E7*
Qty: 3

*Custom divider size required due to desk run length.

Double Float - End Bay

An aluminium upright with base plates supports two laser-cut acrylic panels, both of which have rounded ends to prevent accidental injury and enhance aesthetic appeal. These screens are ideal for use in workspaces with face-to-face seating arrangements.

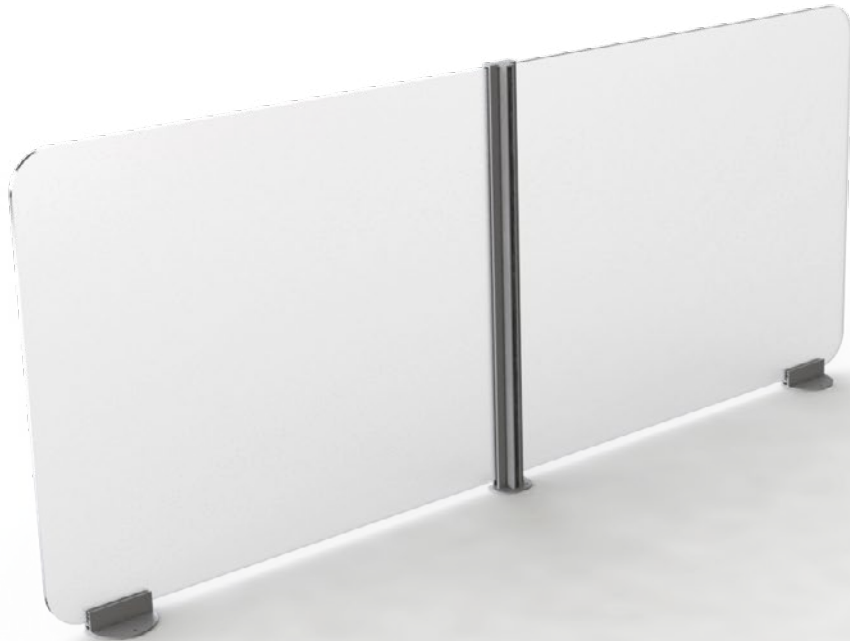

FLT-160x60-END

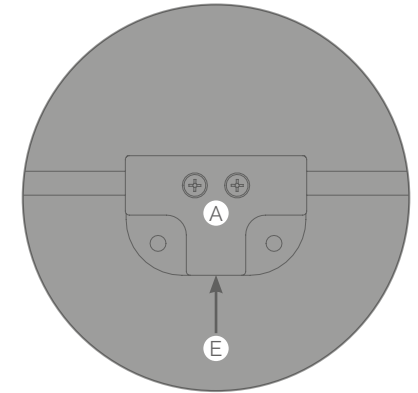
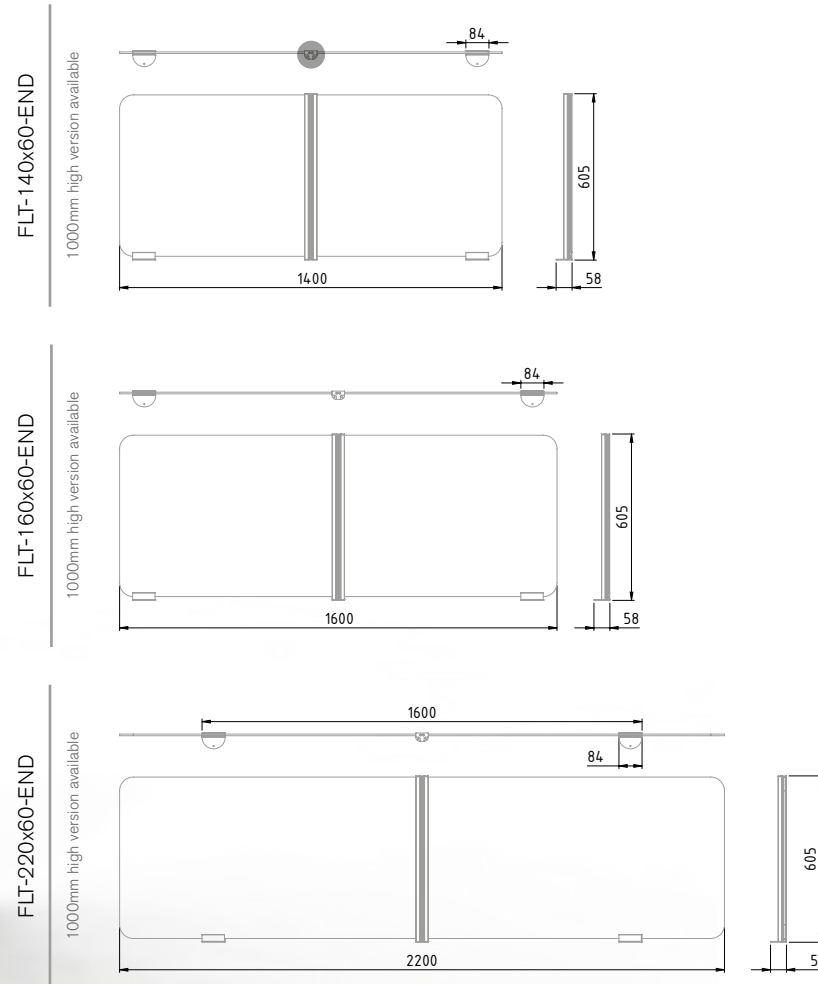

Part Ref.	Product code.	Dimensions mm (WxH)
A1	FLT-140x60-END	1400x600
A2	FLT-160x60-END	1600x600
A3	FLT-220x60-END	2200x600
A4	FLT-140x100-END	1400x1000
A5	FLT-160x100-END	1600x1000
A6	FLT-220x100-END	2200x1000

Custom sizes are available.

Single Float - End Bay

An aluminium upright with base plates supports a single laser-cut acrylic panel which has rounded ends to prevent accidental injury and enhance aesthetic appeal. These screens are ideal for use in workspaces with single-occupancy seating arrangements.



FLT-70x60-END-RH

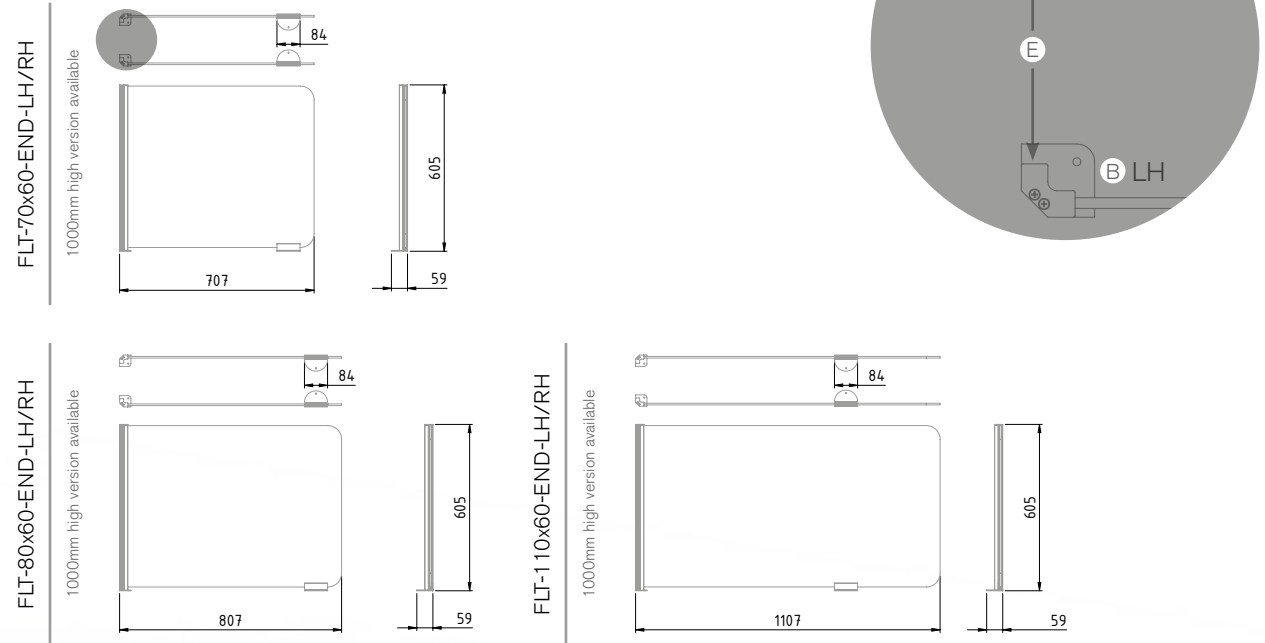

Part Ref.	Product code.	Dimensions mm (WxH)
B1	FLT-70x60-END-LH	700x600
B2	FLT-70x60-END-RH	700x600
B3	FLT-80x60-END-LH	800x600
B4	FLT-80x60-END-RH	800x600
B5	FLT-110x60-END-LH	1100x600
B6	FLT-110x60-END-RH	1100x600
B7	FLT-70x100-END-LH	700x1000
B8	FLT-70x100-END-RH	700x1000
B9	FLT-80x100-END-LH	800x1000
B10	FLT-80x100-END-RH	800x1000
B11	FLT-110x100-END-LH	1100x1000
B12	FLT-110x100-END-RH	1100x1000

Custom sizes are available.

Double Float - Mid Bay

An aluminium upright with base plates supports two laser-cut acrylic panels, both of which have rounded ends to prevent accidental injury and enhance aesthetic appeal. These screens are ideal for use at the mid-point of face-to-face seating arrangements.



FLT-140x60-MID

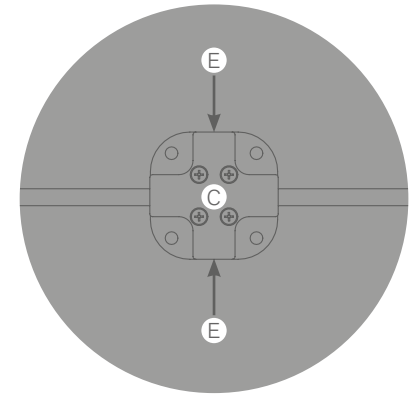
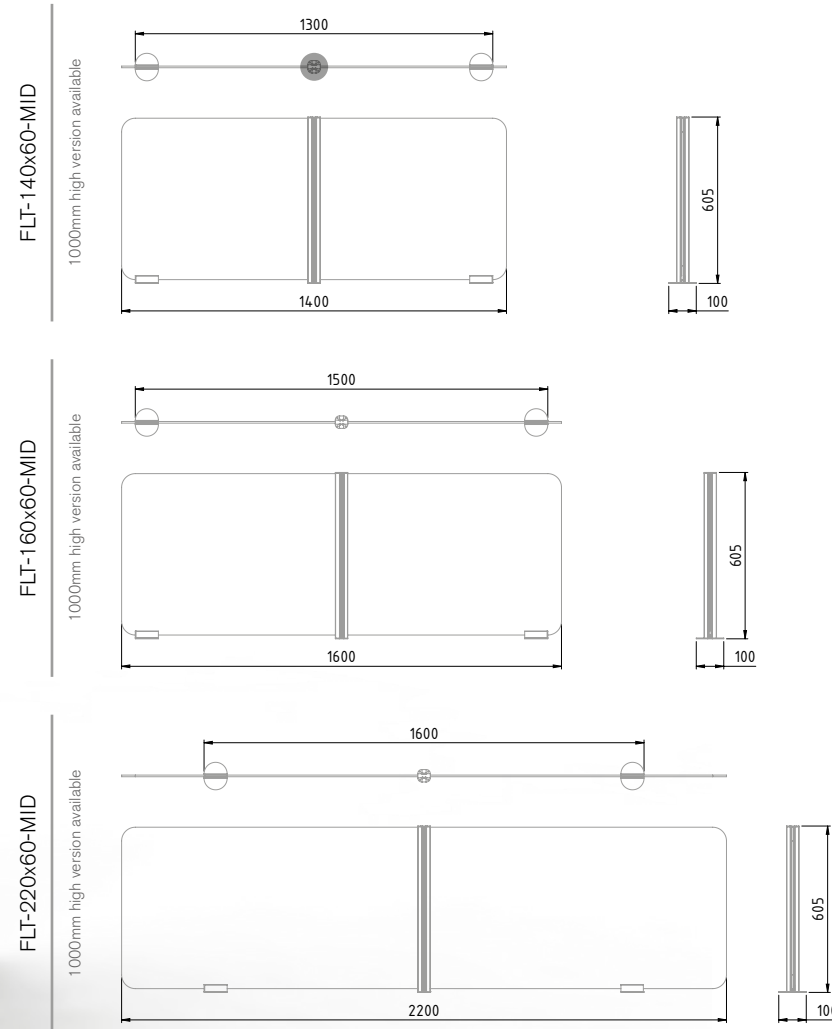

Part Ref.	Product code.	Dimensions mm (WxH)
C1	FLT-140x60-MID	1400x600
C2	FLT-160x60-MID	1600x600
C3	FLT-220x60-MID	2200x600
C4	FLT-140x100-MID	1400x1000
C5	FLT-160x100-MID	1600x1000
C6	FLT-220x100-MID	2200x1000

Custom sizes are available.

Single Float - Mid Bay

An aluminium upright with base plates supports a single laser-cut acrylic panel which has rounded ends to prevent accidental injury and enhance aesthetic appeal. These screens are ideal for use at the mid-point of single-occupancy seating arrangements.



FLT-70x60-MID

FLT-70x60-MID

1000mm high version available

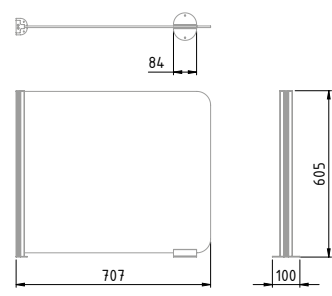

FLT-80x60-MID

1000mm high version available

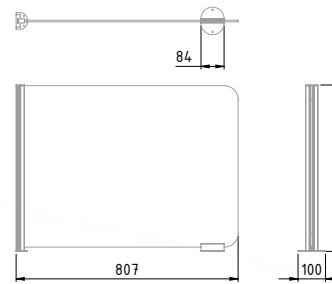

FLT-110x60-MID

1000mm high version available

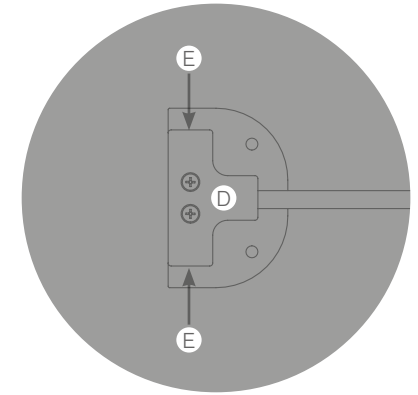
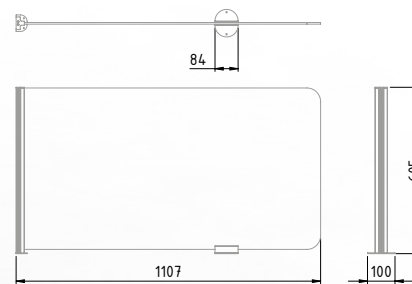

Part Ref.	Product code.	Dimensions mm (WxH)
D1	FLT-70x60-MID	700x600
D2	FLT-80x60-MID	800x600
D3	FLT-110x60-MID	1100x600
D4	FLT-70x100-MID	700x1000
D5	FLT-80x100-MID	800x1000
D6	FLT-110x100-MID	1100x1000

Custom sizes are available.

Float - Divider

The Float range can be reconfigured by using dividers to connect single- and double-screen systems together. Divider panels are available in a multitude of different widths and are compatible with screens designed for both end- and mid-bays.

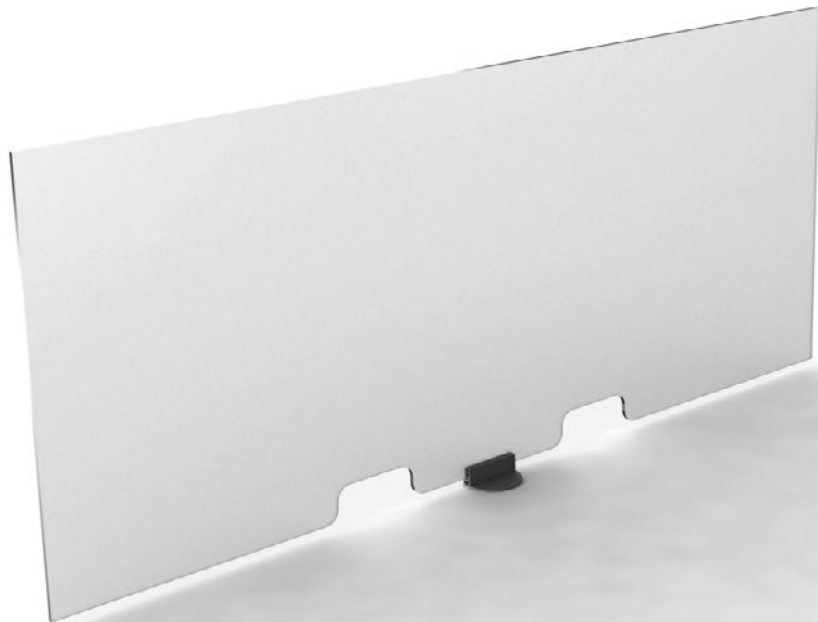

FRM-140-DIV

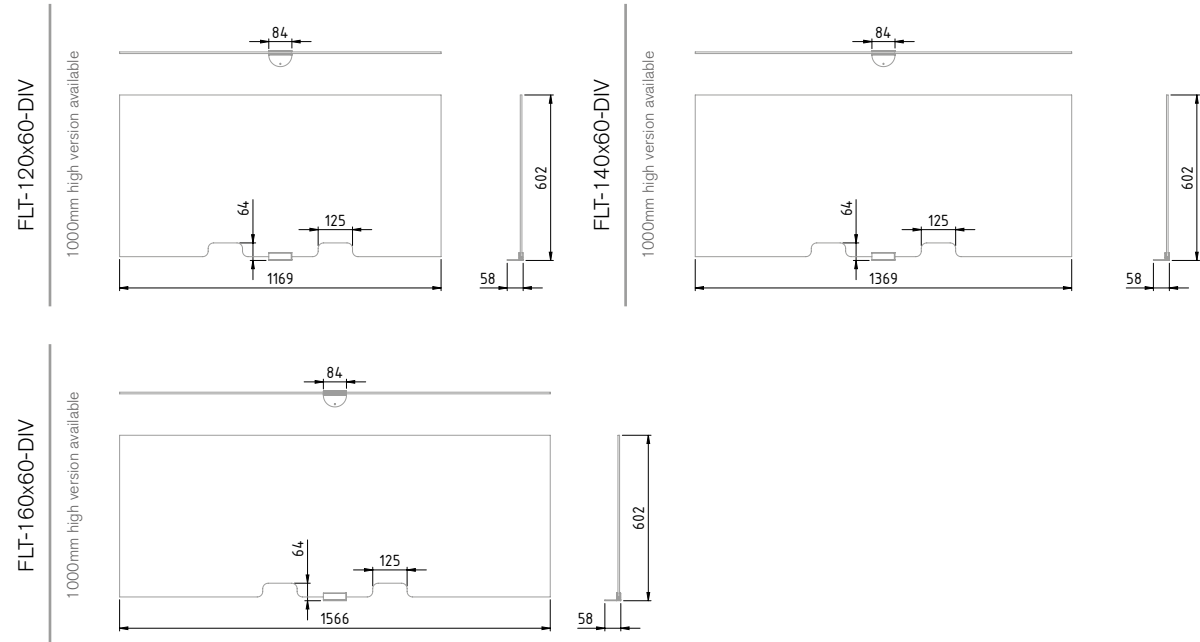

*** For desks in a continuous run (3+) - please provide overall desk dimensions and number of work bays required and we will work out your divider panel size.**

Part Ref.	Product code.	Dimensions mm (WxH)
E1	FLT-120x60-DIV	1200x600
E2	FLT-140x60-DIV	1400x600
E3	FLT-160x60-DIV	1600x600
E4	FLT-120x100-DIV	1200x1000
E5	FLT-140x100-DIV	1400x1000
E6	FLT-160x100-DIV	1600x1000
E7*	FLT-CSTM-DIV*	CUSTOM*

Custom sizes are available.



Float - Wall

FLT-1100x60-WALL

An aluminium upright with base plates supports a single laser-cut acrylic screen which has rounded ends to prevent accidental injury and enhance aesthetic appeal. Each upright is supplied with wall-fixing brackets to provide additional stability.

Available Depths:

(Available 600mm H or 1000mm H)

600mm

700mm

800mm

1100mm

Custom sizes are available please get in touch for more details.



Available with alternative desk mount FIN-DSK-CLMP-02

Product code.	Dimensions mm (DxH)
FLT-60x60-WALL	600x600
FLT-70x60-WALL	700x600
FLT-80x60-WALL	800x600
FLT-110x60-WALL	1100x600
FLT-60x100-WALL	600x1000
FLT-70x100-WALL	700x1000
FLT-80x100-WALL	800x1000
FLT-110x100-WALL	1100x1000
Custom sizes are available.	



Float - Table

FLT-90-TAB

A single aluminium upright with base plates supports four laser-cut acrylic screens. Table Float systems are available in a variety of different diameters making them ideally suited for circular desks of all sizes.

Available to suit standard table diameters:

- 600mm
- 750mm
- 900mm
- 1200mm

Custom sizes are available please get in touch for more details.



Available with alternative desk mount FIN-DSK-CLMP-02

Product code.	Dimensions mm (WxH)
FLT-60-TAB	600
FLT-75-TAB	750
FLT-90-TAB	900
FLT-120-TAB	1200
Custom sizes are available.	

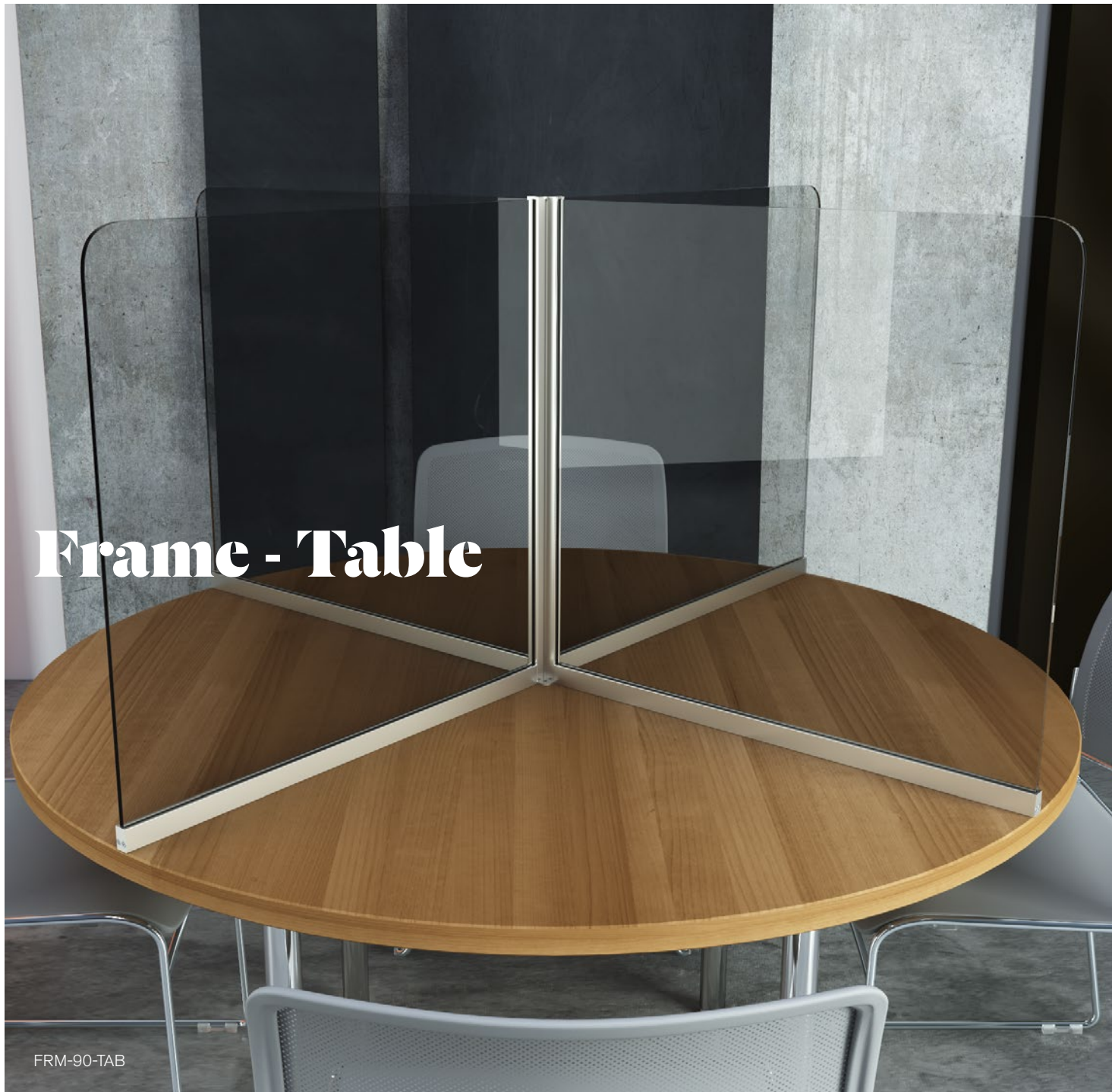

Frame - Table

FRM-90-TAB

The design and functionality of Table Frame is similar to that of Table Float but uses aluminium rails at the base of each fin to achieve a different finish. Table Frames can be discretely yet securely fixed to the surface of desks and meeting tables to deliver effective protection that blends harmoniously with any office environment.

Available to suit standard table diameters:

- 600mm
- 750mm
- 900mm
- 1200mm

Custom sizes are available please get in touch for more details.



Product code.	Dimensions mm (WxH)
FRM-60-TAB	600
FRM-75-TAB	750
FRM-90-TAB	900
FRM-120-TAB	1200
Custom sizes are available.	

Free is a range of protective screens built using anodised aluminium frames and acrylic panels. They are available as either mobile or static units and can be manufactured in a range of standard sizes or to your custom dimensions. Mobile frames are supplied with lockable low-profile castors and deliver highly-flexible protection in a wide variety of environments.

Free





FREE-ST1-1350x500
Used in conjunction with the
Float system.

Free desk screen extenders can be used to create additional divisions between workstations. An aluminium upright with a weighted steel base for stability base plate. Supports a single laser-cut acrylic screen which has rounded ends to prevent accidental injury and enhance aesthetic appeal.

Available depths:

(Available 1350mm H or 1800mm H)

300mm

400mm

500mm

Custom sizes are available please get in touch for more details.

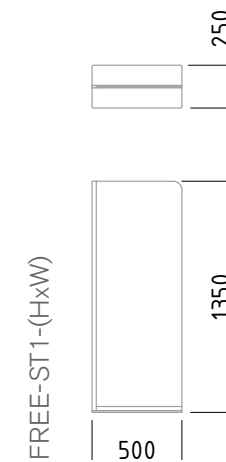



FREE-ST2-(HxW)

FREE-ST3-(HxW)

FREE-ST4-(HxW)

FREE-ST5-(HxW)

FREE-ST6-(HxW)

Weighted base with optional wall fixing brackets.



FREE-ST2-(HxW)



FREE-ST3-(HxW)

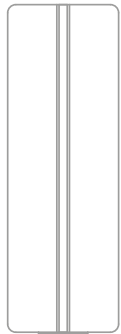

Available Widths:
 (Available 1600mm H, 1800mm H)
 500mm
 600mm
 700mm

Free-Wheeler with locking castors.



FREE-ST4-(HxW)

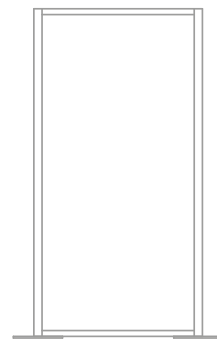

FREE-ST5-(HxW)



FREE-ST6-(HxW)



Available Widths:
 (Available 1600mm H, 1800mm H and 2000mm H)
 800mm
 1000mm
 1200mm
 1600mm

Finishes

When specifying protective screens for your office, meeting room or shared workspace, the importance of addressing health and safety risks cannot be overstated. This does not mean, however, that aesthetic appeal should be sacrificed.

Engineered to perform both effectively and reliably, yet designed to blend seamlessly with any existing interior features, our Safe-Vu screen systems mean you won't be left making uncomfortable compromises.

ohio hartmann
design



Finishes

Safe-Vu screens are available in a wide variety of different finishes to suit environments of all styles.

The aluminium uprights and accessories can be anodised in a range of colours so that, once installed, the entire system will sit harmoniously with existing furniture and decorative themes.

Each panel of laser-cut acrylic is also available in a selection of different finishes, thereby making it easy to create tasteful, elegant screen systems that deliver unparalleled levels of functionality.

Safe-Vu divider screen panels come in 6mm clear acrylic as standard. But other options are available:

- Frosted, coloured/tints and glass effect acrylics.
- PETG
- 6mm toughened glass

Please get in touch for more details sales@unibox.co.uk



Standard anodised aluminium Safe-Vu system with 6mm clear acrylic.



Black anodised aluminium Safe-Vu system with 6mm clear acrylic.



Black anodised aluminium Safe-Vu system with 6mm grey tint acrylic.



Anodised aluminium Safe-Vu system with 6mm frosted acrylic.



Anodised aluminium Safe-Vu system and 6mm clear acrylic with print or vinyl graphics.



Anodised aluminium Safe-Vu system and 6mm clear acrylic with laser etched graphic.

u n i b o x



For more information, speak to our product advisors today.

Alternatively call 205.566.1533
or you can email us for a quick response chris@hartmannndesign.com

www.unibox.co.uk / www.hartmannndesign.com

